

<b>For Consideration By</b>	Licensing Sub-Committee
<b>Meeting Date</b>	6 June 2023
<b>Type of Application</b>	Premises Licence
<b>Address of Premises</b>	Chefs Signature, 22 Well Street, Hackney E9 7PX
<b>Classification</b>	Decision
<b>Ward(s) Affected</b>	Victoria
<b>Group Director</b>	Rickardo Hyatt

1. **Summary**

- 1.1. Kenan Yildirim has made an application for a premises licence under section 17 of the Licensing Act 2003.

2. **Application**

- 2.1. The application seeks to authorise the supply of alcohol for consumption on the premises from Monday to Sunday.
- 2.2. The premises are not located within a Special Policy Area.
- 2.3. The applicant is seeking authorisation for the following licensable activities and times:

<b>Supply of Alcohol On Premises</b>	<b>Standard Hours:</b> Mon 12:00 - 22:30 Tue 12:00 - 22:30 Wed 12:00 - 22:30 Thu 12:00 - 22:30 Fri 12:00 - 22:30 Sat 12:00 - 22:30 Sun 12:00 - 22:30
<b>The opening hours of the premises</b>	<b>Standard Hours:</b> Mon 07:00 - 23:00 Tue 07:00 - 23:00 Wed 07:00 - 23:00 Thu 07:00 - 23:00 Fri 07:00 - 23:00 Sat 07:00 - 23:00 Sun 08:00 - 23:00

2.4. The application is attached as Appendix A. The applicant has proposed conditions as set out in Para 8.1 below. The hours have been amended to 12noon as agreed with the Public Health Authority.

3. **Current Status/History**

3.1. The premises are not licensed for any activity.

3.2. No Temporary Event Notices were submitted for the current calendar year..

4. **Representations: Responsible Authorities**

<b>From</b>	<b>Details</b>
Environmental Health Authority (Environmental Protection)	No representation received
Environmental Health Authority (Environmental Enforcement) <b>Appendix B1</b>	Representation received on the grounds of The Prevention of Public Nuisance
Environmental Health Authority (Health & Safety)	No representation received
Weights and Measures (Trading Standards)	No representation received
Planning Authority <b>Appendix B2</b>	No representation with informative
Area Child Protection Officer	No representation received
Fire Authority	Have confirmed no representation on this application
Police <b>Appendix B3</b>	Representation received on the grounds of The Prevention of Crime and Disorder and The Prevention of Public nuisance
Licensing Authority	No representation received
Health Authority	Representation withdrawn following applicant's agreement to amend the hours for On sale to 12noon

5. **Representations: Other Persons**

<b>From</b>	<b>Details</b>
Representation(s) received from and on behalf of the Other Persons	None

6. **Guidance Considerations**

- 6.1. The Licensing Authority is required to have regard to any guidance issued by the Secretary of State under the Licensing Act 2003.

7. **Policy Considerations**

- 7.1. Licensing Sub-Committee is required to have regard to the London Borough of Hackney's Statement of Licensing Policy ("the Policy) adopted by the Licensing Authority.
- 7.2. The Policy applies to applications where relevant representations have been made. With regard to this application, policies, LP1 (General Principles) and LP2 (Licensing Objectives) are relevant.

8. **Officer Observations**

- 8.1. If the Sub-Committee is minded to approve the application, the following conditions should be applied the licence:

**Mandatory Conditions:**

**Supply of Alcohol (On and Off Premises)**

1. No supply of alcohol may be made under the premises licence:

(a) At a time when there is no designated premises supervisor in respect of the premises licence.

(b) At a time when the designated premises supervisor does not hold a personal licence or his personal licence is suspended.

2. Every supply of alcohol under the premises licence must be made or authorised by a person who holds a personal licence.

3. (1) The responsible person must ensure that staff on relevant premises do not carry out, arrange or participate in any irresponsible promotions in relation to the premises.

(2) In this paragraph, an irresponsible promotion means any one or more of the following activities, or substantially similar activities, carried on for the purpose of encouraging the sale or supply of alcohol for consumption on the premises -

(a) games or other activities which require or encourage, or are designed to require or encourage, individuals to;

(i) drink a quantity of alcohol within a time limit (other than to drink alcohol sold or supplied on the premises before the cessation of the period in which the responsible person is authorised to sell or supply alcohol), or

(ii) drink as much alcohol as possible (whether within a time limit or otherwise);

(b) provision of unlimited or unspecified quantities of alcohol free or for a fixed or discounted fee to the public or to a group defined by a particular characteristic in a manner which carries a significant risk of undermining a licensing objective;

- (c) provision of free or discounted alcohol or any other thing as a prize to encourage or reward the purchase and consumption of alcohol over a period of 24 hours or less in a manner which carries a significant risk of undermining a licensing objective;
- (d) selling or supplying alcohol in association with promotional posters or flyers on, or in the vicinity of, the premises which can reasonably be considered to condone, encourage or glamorise anti-social behaviour or to refer to the effects of drunkenness in any favourable manners.
- (e) dispensing alcohol directly by one person into the mouth of another (other than where that other person is unable to drink without assistance by reason of a disability).

4. The responsible person must ensure that free potable water is provided on request to customers where it is reasonably available.

5.5.1. The premises licence holder or club premises certificate holder must ensure that an age verification policy is adopted in respect of the premises in relation to the sales or supply of alcohol.

5.2 The designated premises supervisor in relation to the premises licences must ensure that the supply of alcohol at the premises is carried on in accordance with the age verification policy.

5.3. The policy must require individuals who appear to the responsible person to be under 18 years of age (or such older age as may be specified in the policy) to produce on request, before being served alcohol, identification bearing their photograph, date of birth and either:-

- (a) a holographic mark or
- (b) an ultraviolet feature

6. The responsible person must ensure that:

a) where any of the following alcoholic drinks is sold or supplied for consumption on the premises (other than alcoholic drinks sold or supplied having been made up in advance ready for sale or supply in a securely closed container) it is available to customers in the following measures:

- beer or cider: 1/2 pint;
- gin, rum, vodka or whisky: 25ml or 35ml; and
- still wine in a glass: 125ml; and

b) these measures are displayed in a menu, price list or other printed material which is available to customers on the premises; and

c) where a customer does not in relation to a sale of alcohol specify the quantity of alcohol to be sold, the customers are made aware that these measures are available.

## Minimum Drinks Pricing

7. 7.1 A relevant person shall ensure that no alcohol is sold or supplied for consumption on or off the premises for a price which is less than the permitted price.

7.2 For the purposes of the condition set out in paragraph 7.1 above -

(a) "duty" is to be construed in accordance with the Alcoholic Liquor Duties Act 1979;

(b) "permitted price" is the price found by applying the formula -

$$P = D + (D \times V)$$

Where -

(i) P is the permitted price,

(ii) D is the rate of duty chargeable in relation to the alcohol as

if the duty were charged on the date of the sale or supply of the alcohol, and

(iii) V is the rate of value added tax chargeable in relation to the alcohol as if the value added tax were charged on the date of the sale or supply of the alcohol;

(c) "relevant person" means, in relation to premises in respect of which there is in force a premises licence -

(i) the holder of the premises licence,

(ii) the designated premises supervisor (if any) in respect of such a licence, or

(iii) the personal licence holder who makes or authorises a supply of alcohol under such a licence;

(d) "relevant person" means, in relation to premises in respect of which there is in force a club premises certificate, any member or officer of the club present on the premises in a capacity which enables the member or officer to prevent the supply in question; and

(e) "value added tax" means value added tax charged in accordance with the Value Added Tax Act 1994.

7.3 Where the permitted price given by Paragraph 7.2(b) above would (apart from

this paragraph) not be a whole number of pennies, the price given by that sub-paragraph shall be taken to be the price actually given by that sub-paragraph rounded up to the nearest penny.

7.4 (1) Sub-paragraph 7.4(2) below applies where the permitted price given by Paragraph 7.2(b) above on a day ("the first day") would be different from the permitted price on the next day ("the second day") as a result of a change to the rate of duty or value added tax.

(2) The permitted price which would apply on the first day applies to sales or supplies of alcohol which take place before the expiry of the period of 14 days beginning on the second day.

**Conditions derived from the operating schedule:**

8. Alcohol will only be served to customers in the lounge area as indicated on the floor plan. Alcohol cannot be consumed in the Hairdresser area of the premises.

9. To install CCTV system which will operate and record video images at all times that the premises are open to the public. All entry and exit points will be covered enabling frontal identification of every person entering the premises in any light condition. - All CCTV recordings made shall be retained for not less than 31 days with time and date stamping and be made available to a police officer or an authorised officer of any responsible authority upon request. Images shall be provided free of charge as soon as reasonably practicable, but not more than 24 hours after the request (subject to the Data Protection Act 1998).

10. The licensee will ensure that the system is checked every two weeks to ensure that the system is working properly and that the date and time are correct. -The Police will be informed if the system will not be operating for longer than one day of business for any reason

11. During opening hours, at least 1 member of staff on duty will be able to operate the system sufficiently to allow Police or authorised Council officers to view footage on request.-

12. Display clear signs at the premises stating `CCTV in Operation

13. Display clear signs stating that anti-social behaviour will not be tolerated

14. A refusal book recording all refused sales of alcohol shall be kept at the premises and maintained at all times, which shall be made available to a police officer or an authorised officer of any responsible authority upon request.

The register will contain:

- a) details of the time and date the refusal was made
- b) the reason for the refusal (including underage and attempted purchase by a person who is drunk)
- c) the identity of the staff member refusing the sale
- d) details of the alcohol the person attempted to purchase
- e) brief description of the customer concerned

15. All incidences of the following shall be recorded in the incident book within 24 hours and retained for a minimum of 12 months.

- a) theft or attempted theft of alcoholic drinks;
- b) any criminal incident;
- c) any incidents of disorder;
- d) all ejections of patrons;
- e) any visit by a relevant authority or the emergency services;
- f) any complaints received;
- g) any faults in the CCTV system
- h) any and all seizures of drugs or offensive weapons;

An incident book shall be kept and maintained at the premises at all times, which shall be made available to a police officer or an authorised officer of any responsible authority upon request. - The incident book shall be used to record the date and time

of any incident, the name of the staff member and a brief description of the customer concerned. -

16. The licence holder shall ensure that staff are trained to use and maintain the refusal book and the incident book. - In the event that crime or serious disorder is, or appears to have been, committed on the premises,

17. The premises will display and maintain appropriate signage advising customers of the contact details of the Designated Premises Supervisor; - There shall be no vertical drinking permitted anywhere on the premises at any time.

18. Training of staff on a regular basis to ensure public safety - The premises licence holder shall ensure that all sales staff receive appropriate training in relation to managing conflict and health and safety of the public and staff. Training documents shall be signed and dated and will be held in a suitable hard-copy log, to be made available to a Police Officer or Council Officer upon request. Records shall be retained for at least 12 months.

19. The sign shall remind customers to respect the neighbours, leave the area quietly and request that they do not congregate outside the premises.

20. To keep deliveries of goods at afternoon times (Delivery times not to be very early or late) - Keeping noise to a minimum at all times.

21. A `Challenge 25` scheme that ensures any person attempting to purchase alcohol who appears to be under the age of 25 shall provide documented proof that he/she is over 18 years of age shall be implemented at the premises. Proof of age shall only comprise a passport, a photo card driving licence, or Proof of Age Standards Scheme (PASS) approved proof of age identity card.

21. A prominent notice, of a size A4 or larger, shall be displayed at the point of entry to the premises and at the serving area advising customers that the premises operates the `Challenge 25` proof of age scheme.

22. All staff whose responsibilities include the retail sale of alcohol shall receive training prior to them being permitted to sell alcohol and refreshed not more than every six months thereafter. the training shall include, but is not restricted to: a) the prevention of underage sales of alcohol which shall include: i. operation of the

23. No one under the age of 18 years will be allowed into the smoking area of the premises.

#### **Conditions derived from Responsible Authorities representations:**

24. The premises shall maintain a comprehensive CCTV system as per the minimum requirements of a Metropolitan Police Crime Prevention Officer. All public areas, entry and exit points will be covered enabling frontal identification of every person entering in any light condition. The CCTV system shall continually record whilst the premises is open for licensable activities and during all times when customers remain on the

premises. All recordings shall be stored for a minimum period of 31 days with date and time stamping. Recordings shall be made available immediately upon the request of Police or authorised officer.

25. A staff member from the premises who is conversant with the operation of the CCTV system shall be on the premises at all times when the premises are open to the public. This staff member shall be able to show Police or an authorised officer of Hackney Borough Council recent data or footage with the absolute minimum of delay when requested.

26. An incident log shall be kept at the premises, and made available immediately to an authorised officer of the Hackney Borough Council or the Police, which will record the following:

- all crimes reported to the venue
- any complaints received
- any incidents of disorder
- any faults in the CCTV system
- any refusal of the sale of alcohol
- any visit by a relevant authority or emergency service.

27. There shall be clear and prominent signage asking all customers to leave quietly and respect local residents.

28. All instances of crime or disorder to be reported by the designated premises supervisor or responsible member of staff to an agreed police contact point, as agreed with the Police.

29. Where the sale or supply of alcohol is taking place employees of the premises must request sight of evidence of the age of any person appearing to be under 25 years of age (Challenge 25). Such evidence may include a driving licence or passport.

30. The premises will display and maintain appropriate signage advising customers of the contact details of the Designated Premises Supervisor.

31. All staff will be given refresher training every six months on the legislation relating to the sales of alcohol to underage persons and drunken persons. Written records of this training shall be kept on the premises and produced to police or other authorised officer upon request.

32. There shall be no open containers or drinks taken outside the premises at any time.

33. Alcohol shall not be sold or supplied for consumption on the premises other than to people taking a substantial table meal from the menu and that the consumption of such alcohol is ancillary to taking table meals. This shall be served by waiter/waitress service.

34. The Licensee shall ensure that all relevant staff are fully trained and made aware of the legal requirement of businesses to comply with their responsibility as regards the disposal of waste produced from the business premises. The procedure for



handling and preparing for disposal of the waste shall be in writing and displayed in a prominent place where it can be referred to at all times by staff.

35. The Licensee shall ensure that any contract for general and recyclable waste disposal shall be appropriate in size to the amount of waste produced by the business. The Licensee shall maintain an adequate supply of waste receptacles provided by his registered waste carrier (refuse sacks or commercial waste bins) in order to ensure all refuse emanating from the business is always presented for collection by his waste carrier and shall not use any plain black or unidentifiable refuse sacks or any other unidentifiable or unmarked waste receptacles.

36. The Licensee's premises are situated in an area within which refuse may only be left on the public highway at certain times (time bands). If the Licensee's waste carrier cannot or does not comply by collecting the refuse within an hour after the close of any time band imposed by the waste authority, the Licensee must remove the refuse from the public highway and/or keep it within the premises until such time as his/her waste carrier arrives to collect the refuse.

37. The Licensee shall instruct members of staff to make regular checks of the area immediately outside the premises and remove any litter, bottles and glasses emanating from the premises. A final check should be made at close of business.

38.. The Licensee shall provide a safe receptacle for cigarette ends to be placed outside for the use of customers, such receptacle being carefully placed so as not to cause an obstruction or trip.

39. The current trade waste agreement/duty of care waste transfer document shall be conspicuously displayed and maintained in the window of the premises where it can be conveniently seen and read by persons standing in Chef's Signature. This should remain unobstructed at all times and should clearly identify:- the name of the registered waste carrier the date of commencement of trade waste contract the date of expiry of trade waste contract the days and times of collection the type of waste including the European Waste Code

## 9. **Reasons for Officer Observations**

- 8.1. Conditions 9 to 23 are derived from the applicant's operating schedule, conditions 24 to 33 have been suggested by the Police Authority and conditions 34 to 39 have been suggested by the Environmental Enforcement Authority.

## 10. **Legal Comments**

- 10.1. The Council has a duty as a Licensing Authority under the Licensing Act 2003 to carry out its functions with a view to promoting the following licensing objectives;
- The Prevention of Crime and Disorder
  - Public Safety
  - Prevention of Public Nuisance
  - The Protection of Children from Harm

10.2. It should be noted that each of the licensing objectives have equal importance and are the only grounds upon which a relevant representation can be made and for which an application can be refused or terms and conditions attached to a licence.

11. **Human Rights Act 1998 Implications**

- 11.1. There are implications to;
- **Article 6** – Right to a fair hearing
  - **Article 14** – Not to discriminate
  - Balancing: **Article 1**- Peaceful enjoyment of their possession (i.e. a licence is defined as being a possession) with **Article 8** – Right of Privacy (i.e. respect private & family life) to achieve a proportionate decision having regard to the protection of an individuals rights against the interests of the community at large.

12. **Members Decision Making**

12.1. **Option 1**

**That the application be refused**

12.2. **Option 2**

**That the application be approved, together with any conditions or restrictions which Members consider necessary for the promotion of the Licensing objectives.**

13. **Conclusion**

13.1. That Members decide on the application under the Licensing Act 2003.

**Appendices:**

Appendix A: Application for a premises licence and supporting documents  
Appendix B: Representations from responsible authorities  
Appendix C: Location map

**Background documents**

Licensing Act 2003  
LBH Statement of Licensing Policy

<b>Report Author</b>	Name: Sanaria Hussain Title: Senior Licensing Officer Email: sanaria.hussain@hackney.gov.uk Tel: 020 8356 4972
----------------------	---

# Appendix A

**Hackney**  
**LA01**

**Application for a premises licence to be granted under the Licensing Act 2003**

## PLEASE READ THE FOLLOWING INSTRUCTIONS FIRST

Before completing this form please read the guidance notes at the end of the form. If you are completing this form by hand please write legibly in block capitals. In all cases ensure that your answers are inside the boxes and written in black ink. Use additional sheets if necessary.

You may wish to keep a copy of the completed form for your records.

I/We MR KENAN YILDIRIM

*(Insert name(s) of applicant)*

**apply for a premises licence under section 17 of the Licensing Act 2003 for the premises described in Part 1 below (the premises) and I/we are making this application to you as the relevant licensing authority in accordance with section 12 of the Licensing Act 2003**

### Part 1 – Premises details

Postal address of premises or, if none, ordnance survey map reference or description  
CHEFS SIGNATURE, 22 WELL STREET

**Post town**

LONDON

**Postcode**

E9 7PX

Telephone number at premises (if any)

Non-domestic rateable value of premises

**£12500**

### Part 2 - Applicant details

Please state whether you are applying for a premises licence as **appropriate** Please tick as **appropriate**

- a) an individual or individuals \*  please complete section (A)
- b) a person other than an individual \*
- i as a limited company/limited liability partnership  please complete section (B)
- ii as a partnership (other than limited liability)  please complete section (B)
- iii as an unincorporated association or  please complete section (B)
- iv other (for example a statutory corporation)  please complete section (B)

- c) a recognised club  please complete section (B)
- d) a charity  please complete section (B)
- e) the proprietor of an educational establishment  please complete section (B)
- f) a health service body  please complete section (B)
- g) a person who is registered under Part 2 of the Care Standards Act 2000 (c14) in respect of an independent hospital in Wales  please complete section (B)
- ga) a person who is registered under Chapter 2 of Part 1 of the Health and Social Care Act 2008 (within the meaning of that Part) in an independent hospital in England  please complete section (B)
- h) the chief officer of police of a police force in England and Wales  please complete section (B)

\* If you are applying as a person described in (a) or (b) please confirm (by ticking yes to one box below):

- I am carrying on or proposing to carry on a business which involves the use of the premises for licensable activities; or
- I am making the application pursuant to a
  - statutory function or
  - a function discharged by virtue of Her Majesty's prerogative

**(A) INDIVIDUAL APPLICANTS** (fill in as applicable)

Mr <input checked="" type="checkbox"/>	Mrs <input type="checkbox"/>	Miss <input type="checkbox"/>	Ms <input type="checkbox"/>	Other Title (for example, Rev)	
<b>Surname</b> YILDIRIM			<b>First names</b> KENAN		
<b>Date of birth</b> [REDACTED]		I am 18 years old or over		<input checked="" type="checkbox"/> Please tick yes	
<b>Nationality</b> BRITISH					
Current residential address if different from premises address		[REDACTED]			
Post town		LONDON		Postcode	[REDACTED]
<b>Daytime contact telephone number</b>		[REDACTED]			
<b>E-mail address</b>		[REDACTED]			

(optional)	
<b>Where applicable (if demonstrating a right to work via the Home Office online right to work checking service), the 9-digit 'share code' provided to the applicant by that service (please see note 15 for information)</b>	

**SECOND INDIVIDUAL APPLICANT** (if applicable)

Mr <input type="checkbox"/>	Mrs <input type="checkbox"/>	Miss <input type="checkbox"/>	Ms <input type="checkbox"/>	Other Title (for example, Rev)	
<b>Surname</b>			<b>First names</b>		
<b>Date of birth</b>		I am 18 years old or over		<input type="checkbox"/>	Please tick yes
<b>Nationality</b>					
Current postal address if different from premises address					
Post town				Postcode	
<b>Daytime contact telephone number</b>					
<b>E-mail address (optional)</b>					
<b>Where applicable (if demonstrating a right to work via the Home Office online right to work checking service), the 9-digit 'share code' provided to the applicant by that service (please see note 15 for information)</b>					

**(B) OTHER APPLICANTS**

**Please provide name and registered address of applicant in full. Where appropriate please give any registered number. In the case of a partnership or other joint venture (other than a body corporate), please give the name and address of each party concerned.**

<b>Name</b> HALIT ERTAS
<b>Address</b> 54C CANNON HILL MEWS LONDON, N14 6LH

Registered number (where applicable) N/A
Description of applicant (for example, partnership, company, unincorporated association etc.) AGENT
Telephone [REDACTED] +[REDACTED]
E-mail address (optional) [REDACTED]

**Part 3 Operating Schedule**

When do you want the premises licence to start?

DD	MM	YYYY
0 1	0 4	2 0 2 3

If you wish the licence to be valid only for a limited period, when do you want it to end?

DD	MM	YYYY

Please give a general description of the premises (please read guidance note 1) GROUND FLOOR CAFÉ (E)
--

If 5,000 or more people are expected to attend the premises at any one time, please state the number expected to attend.

0
---

What licensable activities do you intend to carry on from the premises?

(Please see sections 1 and 14 and Schedules 1 and 2 to the Licensing Act 2003)

Provision of regulated entertainment (please read guidance note 2) Please tick all that apply

- a) plays (if ticking yes, fill in box A)
- b) films (if ticking yes, fill in box B)
- c) indoor sporting events (if ticking yes, fill in box C)
- d) boxing or wrestling entertainment (if ticking yes, fill in box D)
- e) live music (if ticking yes, fill in box E)
- f) recorded music (if ticking yes, fill in box F)
- g) performances of dance (if ticking yes, fill in box G)
- h) anything of a similar description to that falling within (e), (f) or (g) (if ticking yes, fill in box H)
- Provision of late night refreshment** (if ticking yes, fill in box I)
- Supply of alcohol** (if ticking yes, fill in box J)

**In all cases complete boxes K, L and M**

**A**

<b>Plays</b> Standard days and timings (please read	<b>Will the performance of a play take place indoors or outdoors or both – please tick</b> (please read guidance note 3)	Indoors	<input type="checkbox"/>
--	--	---------	--------------------------

guidance note 7)				Outdoors	<input type="checkbox"/>
Day	Start	Finish		Both	<input type="checkbox"/>
Mon			<b>Please give further details here</b> (please read guidance note 4)		
Tue					
Wed			<b>State any seasonal variations for performing plays</b> (please read guidance note 5)		
Thur					
Fri			<b>Non-standard timings. Where you intend to use the premises for the performance of plays at different times to those listed in the column on the left, please list</b> (please read guidance note 6)		
Sat					
Sun					



**B**

<b>Films</b> Standard days and timings (please read guidance note 7)			<b>Will the exhibition of films take place indoors or outdoors or both – please tick</b> (please read guidance note 3)	Indoors	<input type="checkbox"/>
				Outdoors	<input type="checkbox"/>
Day	Start	Finish		Both	<input type="checkbox"/>
Mon			<b>Please give further details here</b> (please read guidance note 4)		
Tue			<b>State any seasonal variations for the exhibition of films</b> (please read guidance note 5)		
Wed			<b>Non-standard timings. Where you intend to use the premises for the exhibition of films at different times to those listed in the column on the left, please list</b> (please read guidance note 6)		
Thur					
Fri					
Sat					
Sun					

**C**

<b>Indoor sporting events</b> Standard days and timings (please read guidance note 7)			<b>Please give further details</b> (please read guidance note 4)	
Day	Start	Finish		
Mon			<b>State any seasonal variations for indoor sporting events</b> (please read guidance note 5)	
Tue				
Wed				
Thur				<b>Non-standard timings. Where you intend to use the premises for indoor sporting events at different times to those listed in the column on the left, please list</b> (please read guidance note 6)
Fri				
Sat				
Sun				

**D**

<b>Boxing or wrestling entertainments</b> Standard days and timings (please read guidance note 7)			<b>Will the boxing or wrestling entertainment take place indoors or outdoors or both – please tick</b> (please read guidance note 3)	Indoors	<input type="checkbox"/>
				Outdoors	<input type="checkbox"/>
				Both	<input type="checkbox"/>
Day	Start	Finish	<b>Please give further details here</b> (please read guidance note 4)		
Mon					
Tue					
Wed			<b>State any seasonal variations for boxing or wrestling entertainment</b> (please read guidance note 5)		
Thur					
Fri			<b>Non-standard timings. Where you intend to use the premises for boxing or wrestling entertainment at different times to those listed in the column on the left, please list</b> (please read guidance note 6)		
Sat					
Sun					

**E**

<b>Live music</b> Standard days and timings (please read guidance note 7)			<b>Will the performance of live music take place indoors or outdoors or both – please tick</b> (please read guidance note 3)	Indoors	<input type="checkbox"/>
				Outdoors	<input type="checkbox"/>
				Both	<input type="checkbox"/>
<b>Day</b>	<b>Start</b>	<b>Finish</b>	<b>Please give further details here</b> (please read guidance note 4)		
Mon					
Tue					
			<b>State any seasonal variations for the performance of live music</b> (please read guidance note 5)		
Wed					
Thur					
			<b>Non-standard timings. Where you intend to use the premises for the performance of live music at different times to those listed in the column on the left, please list</b> (please read guidance note 6)		
Fri					
Sat					
Sun					

**F**

<b>Recorded music</b> Standard days and timings (please read guidance note 7)			<b>Will the playing of recorded music take place indoors or outdoors or both – please tick</b> (please read guidance note 3)	Indoors	<input type="checkbox"/>
				Outdoors	<input type="checkbox"/>
				Both	<input type="checkbox"/>
Day	Start	Finish	<b>Please give further details here</b> (please read guidance note 4)		
Mon					
Tue					
Wed					
			<b>State any seasonal variations for the playing of recorded music</b> (please read guidance note 5)		
Thur					
			<b>Non-standard timings. Where you intend to use the premises for the playing of recorded music at different times to those listed in the column on the left, please list</b> (please read guidance note 6)		
Fri					
Sat					
Sun					

**G**

<b>Performances of dance</b> Standard days and timings (please read guidance note 7)			<b>Will the performance of dance take place indoors or outdoors or both – please tick</b> (please read guidance note 3)	Indoors	<input type="checkbox"/>
				Outdoors	<input type="checkbox"/>
				Both	<input type="checkbox"/>
Day	Start	Finish	<b>Please give further details here</b> (please read guidance note 4)		
Mon					
Tue					
			<b>State any seasonal variations for the performance of dance</b> (please read guidance note 5)		
Wed					
Thur					
			<b>Non-standard timings. Where you intend to use the premises for the performance of dance at different times to those listed in the column on the left, please list</b> (please read guidance note 6)		
Fri					
Sat					
Sun					

H

<b>Anything of a similar description to that falling within (e), (f) or (g)</b> Standard days and timings (please read guidance note 7)			<b>Please give a description of the type of entertainment you will be providing</b>		
Day	Start	Finish	<b>Will this entertainment take place indoors or outdoors or both – please tick</b> (please read guidance note 3)	Indoors	<input type="checkbox"/>
Mon				Outdoors	<input type="checkbox"/>
				Both	<input type="checkbox"/>
Tue			<b>Please give further details here</b> (please read guidance note 4)		
Wed					
Thur			<b>State any seasonal variations for entertainment of a similar description to that falling within (e), (f) or (g)</b> (please read guidance note 5)		
Fri					
Sat			<b>Non-standard timings. Where you intend to use the premises for the entertainment of a similar description to that falling within (e), (f) or (g) at different times to those listed in the column on the left, please list</b> (please read guidance note 6)		
Sun					

I

<b>Late night refreshment</b> Standard days and timings (please read guidance note 7)			<b>Will the provision of late night refreshment take place indoors or outdoors or both – please tick</b> (please read guidance note 3)	Indoors	<input type="checkbox"/>
				Outdoors	<input type="checkbox"/>
				Both	<input type="checkbox"/>
<b>Day</b>	<b>Start</b>	<b>Finish</b>	<b>Please give further details here</b> (please read guidance note 4)		
Mon					
Tue					
			<b>State any seasonal variations for the provision of late night refreshment</b> (please read guidance note 5)		
Wed					
Thur					
			<b>Non-standard timings. Where you intend to use the premises for the provision of late night refreshment at different times, to those listed in the column on the left, please list</b> (please read guidance note 6)		
Fri					
Sat					
Sun					



**J**

<b>Supply of alcohol</b> Standard days and timings (please read guidance note 7)			<b>Will the supply of alcohol be for consumption – please tick</b> (please read guidance note 8)	On the premises	<input checked="" type="checkbox"/>
				Off the premises	<input type="checkbox"/>
				Both	<input type="checkbox"/>
<b>Day</b>	<b>Start</b>	<b>Finish</b>	<b>State any seasonal variations for the supply of alcohol</b> (please read guidance note 5)		
Mon	07:00	22:30			
Tue	07:00	22:30			
Wed	07:00	22:30			
Thur	07:00	22:30			
Fri	07:00	22:30			
Sat	07:00	22:30			
Sun	08:00	22:30			
			<b>Non-standard timings. Where you intend to use the premises for the supply of alcohol at different times to those listed in the column on the left, please list</b> (please read guidance note 6) CHRISTMAS DAY 12:00 - 15:00 AND 19:00 - 22:30		

**State the name and details of the individual whom you wish to specify on the licence as designated premises supervisor (Please see declaration about the entitlement to work in the checklist at the end of the form):**

<b>Name</b> MR KENAN YILDIRIM	
<b>Date of birth</b> [REDACTED]	
<b>Address</b> [REDACTED]	
<b>Postcode</b>	[REDACTED]
<b>Personal licence</b> [REDACTED]	
<b>Issuing licensing authority (if known)</b> HACKNEY COUNCIL	

**K**

**Please highlight any adult entertainment or services, activities, other entertainment or matters ancillary to the use of the premises that may give rise to concern in respect of children** (please read guidance note 9).

N/A

**L**

<b>Hours premises are open to the public</b> Standard days and timings (please read guidance note 7)			<b>State any seasonal variations</b> (please read guidance note 5)
Day	Start	Finish	
Mon	07:00	23:00	<b>Non-standard timings. Where you intend the premises to be open to the public at different times from those listed in the column on the left, please list</b> (please read guidance note 6) CHRISTMAS DAY 12:00 - 23:00
Tue	07:00	23:00	
Wed	07:00	23:00	
Thur	07:00	23:00	
Fri	07:00	23:00	
Sat	07:00	23:00	
Sun	08:00	23:00	

**M** Describe the steps you intend to take to promote the four licensing objectives:

**a) General – all four licensing objectives (b, c, d and e)** (please read guidance note 10)

All four licensing objectives to be in place and to be implemented to protect public nuisance and children away from harm.

**b) The prevention of crime and disorder**

Alcohol will only be served to customers in the lounge area as indicated on the floor plan. Alcohol cannot be consumed in the Hairdresser area of the premises.

- To liaise with the local police
- To install CCTV system which will operate and record video images at all times that the premises are open to the public. All entry and exit points will be covered enabling frontal identification of every person entering the premises in any light condition.
- All CCTV recordings made shall be retained for not less than 31 days with time and date stamping and be made available to a police officer or an authorised officer of any responsible authority upon request. Images shall be provided free of charge as soon as reasonably practicable, but not more than 24 hours after the request (subject to the Data Protection Act 1998).
- The licensee will ensure that the system is checked every two weeks to ensure that the system is working properly and that the date and time are correct.
- The Police will be informed if the system will not be operating for longer than one day of business for any reason;
- During opening hours, at least 1 member of staff on duty will be able to operate the system sufficiently to allow Police or authorised Council officers to view footage on request;
- Display clear signs at the premises stating `CCTV in Operation`
- Display clear signs stating that anti-social behaviour will not be tolerated
- Do not sell alcohol to drunk person
- A refusal book recording all refused sales of alcohol shall be kept at the premises and maintained at all times, which shall be made available to a police officer or an authorised officer of any responsible authority upon request. The register will contain:
  - a) details of the time and date the refusal was made
  - b) the reason for the refusal (including underage and attempted purchase by a person who is drunk)
  - c) the identity of the staff member refusing the sale
  - d) details of the alcohol the person attempted to purchase
  - e) brief description of the customer concerned
- An incident book shall be kept and maintained at the premises at all times, which shall be made available to a police officer or an authorised officer of any responsible authority upon request.
- The incident book shall be used to record the date and time of any incident, the name of the staff member and a brief description of the customer concerned.
- All incidences of the following shall be recorded in the incident book within 24 hours and retained for a minimum of 12 months.
  - a) theft or attempted theft of alcoholic drinks;
  - b) any criminal incident;
  - c) any incidents of disorder;
  - d) all ejections of patrons;
  - e) any visit by a relevant authority or the emergency services;
  - f) any complaints received;
  - g) any faults in the CCTV system;

- h) any and all seizures of drugs or offensive weapons;
- The licence holder shall ensure that staff are trained to use and maintain the refusal book and the incident book.
  - In the event that crime or serious disorder is, or appears to have been, committed on the premises, the management will immediately ensure that:
    - (a) The police and, where appropriate, the London Ambulance Service, are called immediately;
    - (b) As far as is safe and reasonable practicable, all measures will be taken to apprehend any identified suspects pending the arrival of the police;
    - (c) As far as is safe and reasonable practicable, all measures will be taken to preserve any identified crime scene pending the arrival of the police.
  - The premises will display and maintain appropriate signage advising customers of the contact details of the Designated Premises Supervisor;
  - There shall be no vertical drinking permitted anywhere on the premises at any time.

### **c) Public safety**

- To meet all health and safety objectives
- Liaise with the local police
- Training of staff on a regular basis to ensure public safety
- The premises licence holder shall ensure that all sales staff receive appropriate training in relation to managing conflict and health and safety of the public and staff. Training documents shall be signed and dated and will be held in a suitable hard-copy log, to be made available to a Police Officer or Council Officer upon request. Said records shall be retained for at least 12 months.
- Do not sell alcohol to underage persons, always check ID's if in doubt about person's age.

### **d) The prevention of public nuisance**

- Customers requested to leave the premises in a quiet and orderly manners. A suitably worded sign, of a size A4 or larger, shall be displayed at each exit point from the premises. The sign shall remind customers to respect the neighbours, leave the area quietly and request that they do not congregate outside the premises.
- The licensee shall ensure that the management and staff prevent the admission of, and ensure the prompt departure from the premises of, any and all drunk and or disorderly people or other people displaying signs of other substance use, without causing any disorder;
- To keep deliveries of goods at afternoon times (Delivery times not to be very early or late)
- Keeping noise to a minimum at all times.

### **e) The protection of children from harm**

- Clear signs displayed to warn families to keep children with them at all times
- To keep sharp and flammable objects from children
- Do not sell alcohol to underage persons. A `Challenge 25` scheme that ensures any person attempting to purchase alcohol who appears to be under the age of 25 shall provide documented proof that he/she is over 18 years of age shall be implemented at the premises. Proof of age shall only comprise a passport, a photo card driving licence, or Proof of Age Standards Scheme (PASS) approved proof of age identity card.
- A prominent notice, of a size A4 or larger, shall be displayed at the point of entry to the premises and at the serving area advising customers that the premises operates the `Challenge 25` proof of

age scheme.

- All staff whose responsibilities include the retail sale of alcohol shall receive training prior to them being permitted to sell alcohol and refreshed not more than every six months thereafter. the training shall include, but is not restricted to:

a) the prevention of underage sales of alcohol which shall include:

i. operation of the `Challenge 25` scheme;

ii. types of acceptable ID;

iii. method of recording challenges;

iv. potential consequences of making an underage sale.

b) refusing sales of alcohol to persons who appear to be drunk;

c) identifying and preventing proxy sales;

d) the operation of the CCTV equipment.

Such training shall be recorded, a version of which must be kept in English and these records shall, on request, be made available to any police officer or authorised person upon demand;

- No one under the age of 18 years will be allowed into the smoking area of the premises.

### Checklist:

**Please tick to indicate agreement**

- I have made or enclosed payment of the fee.
- I have enclosed the plan of the premises.
- I have sent copies of this application and the plan to responsible authorities and others where applicable.
- I have enclosed the consent form completed by the individual I wish to be designated premises supervisor, if applicable.
- I understand that I must now advertise my application.
- I understand that if I do not comply with the above requirements my application will be rejected.
- [Applicable to all individual applicants, including those in a partnership which is not a limited liability partnership, but not companies or limited liability partnerships] I have included documents demonstrating my entitlement to work in the United Kingdom or my share code issued by the Home Office online right to work checking service (please read note 15).

**IT IS AN OFFENCE, UNDER SECTION 158 OF THE LICENSING ACT 2003, TO MAKE A FALSE STATEMENT IN OR IN CONNECTION WITH THIS APPLICATION. THOSE WHO MAKE A FALSE STATEMENT MAY BE LIABLE ON SUMMARY CONVICTION TO A FINE OF ANY AMOUNT.**

**IT IS AN OFFENCE UNDER SECTION 24B OF THE IMMIGRATION ACT 1971 FOR A PERSON TO WORK WHEN THEY KNOW, OR HAVE REASONABLE CAUSE TO BELIEVE, THAT THEY ARE DISQUALIFIED FROM DOING SO BY REASON OF THEIR IMMIGRATION STATUS. THOSE WHO EMPLOY AN ADULT WITHOUT LEAVE OR WHO IS SUBJECT TO CONDITIONS AS TO EMPLOYMENT WILL BE LIABLE TO A CIVIL PENALTY UNDER SECTION 15 OF THE IMMIGRATION, ASYLUM AND NATIONALITY ACT 2006 AND PURSUANT TO SECTION 21 OF THE SAME ACT, WILL BE COMMITTING AN OFFENCE WHERE THEY DO SO IN THE KNOWLEDGE, OR WITH REASONABLE CAUSE TO BELIEVE, THAT THE EMPLOYEE IS DISQUALIFIED.**

**Part 4 – Signatures** (please read guidance note 11)

**Signature of applicant or applicant’s solicitor or other duly authorised agent** (see guidance note 12). **If signing on behalf of the applicant, please state in what capacity.**

<b>Declaration</b>	<ul style="list-style-type: none"><li>• [Applicable to individual applicants only, including those in a partnership which is not a limited liability partnership] I understand I am not entitled to be issued with a licence if I do not have the entitlement to live and work in the UK (or if I am subject to a condition preventing me from doing work relating to the carrying on of a licensable activity) and that my licence will become invalid if I cease to be entitled to live and work in the UK (please read guidance note 15).</li><li>• The DPS named in this application form is entitled to work in the UK (and is not subject to conditions preventing him or her from doing work relating to a licensable activity) and I have seen a copy of his or her proof of entitlement to work, or have conducted an online right to work check using the Home Office right to work checking service which confirmed their right to work (please see note 15)</li></ul>
Signature	
Date	08/03/2023
Capacity	APPLICANT

**For joint applications, signature of 2<sup>nd</sup> applicant or 2<sup>nd</sup> applicant’s solicitor or other authorised agent** (please read guidance note 13). **If signing on behalf of the applicant, please state in what capacity.**

Signature	<i>H. Entas</i>
Date	08/03/2023
Capacity	AGENT

Contact name (where not previously given) and postal address for correspondence associated with this application (please read guidance note 14)

██████████

Post town

██████████

Postcode

██████████

Telephone number (if any)

██████████

If you would prefer us to correspond with you by e-mail, your e-mail address (optional)

██████████

### Notes for Guidance

1. Describe the premises, for example the type of premises, its general situation and layout and any other information which could be relevant to the licensing objectives. Where your application includes off-supplies of alcohol and you intend to provide a place for consumption of these off-supplies, you must include a description of where the place will be and its proximity to the premises.
2. In terms of specific regulated entertainments please note that:
  - Plays: no licence is required for performances between 08:00 and 23.00 on any day, provided that the audience does not exceed 500.
  - Films: no licence is required for 'not-for-profit' film exhibition held in community premises between 08.00 and 23.00 on any day provided that the audience does not exceed 500 and the organiser (a) gets consent to the screening from a person who is responsible for the premises; and (b) ensures that each such screening abides by age classification ratings.
  - Indoor sporting events: no licence is required for performances between 08.00 and 23.00 on any day, provided that the audience does not exceed 1000.
  - Boxing or Wrestling Entertainment: no licence is required for a contest, exhibition or display of Greco-Roman wrestling, or freestyle wrestling between 08.00 and 23.00 on any day, provided that the audience does not exceed 1000. Combined fighting sports – defined as a contest, exhibition or display which combines boxing or wrestling with one or more martial arts – are licensable as a boxing or wrestling entertainment rather than an indoor sporting event.
  - Live music: no licence permission is required for:
    - a performance of unamplified live music between 08.00 and 23.00 on any day, on any premises.
    - a performance of amplified live music between 08.00 and 23.00 on any day on premises authorised to sell alcohol for consumption on those premises, provided that the audience does not exceed 500.
    - a performance of amplified live music between 08.00 and 23.00 on any day, in a workplace that is not licensed to sell alcohol on those premises, provided that the audience does not exceed 500.
    - a performance of amplified live music between 08.00 and 23.00 on any day, in a church hall, village hall, community hall,

- or other similar community premises, that is not licensed by a premises licence to sell alcohol, provided that (a) the audience does not exceed 500, and (b) the organiser gets consent for the performance from a person who is responsible for the premises.
  - a performance of amplified live music between 08.00 and 23.00 on any day, at the non-residential premises of (i) a local authority, or (ii) a school, or (iii) a hospital, provided that (a) the audience does not exceed 500, and (b) the organiser gets consent for the performance on the relevant premises from: (i) the local authority concerned, or (ii) the school or (iii) the health care provider for the hospital.
- Recorded Music: no licence permission is required for:
  - any playing of recorded music between 08.00 and 23.00 on any day on premises authorised to sell alcohol for consumption on those premises, provided that the audience does not exceed 500.
  - any playing of recorded music between 08.00 and 23.00 on any day, in a church hall, village hall, community hall, or other similar community premises, that is not licensed by a premises licence to sell alcohol, provided that (a) the audience does not exceed 500, and (b) the organiser gets consent for the performance from a person who is responsible for the premises.
  - any playing of recorded music between 08.00 and 23.00 on any day, at the non-residential premises of (i) a local authority, or (ii) a school, or (iii) a hospital, provided that (a) the audience does not exceed 500, and (b) the organiser gets consent for the performance on the relevant premises from: (i) the local authority concerned, or (ii) the school proprietor or (iii) the health care provider for the hospital.
- Dance: no licence is required for performances between 08.00 and 23.00 on any day, provided that the audience does not exceed 500. However, a performance which amounts to adult entertainment remains licensable.
- Cross activity exemptions: no licence is required between 08.00 and 23.00 on any day, with no limit on audience size for:
  - any entertainment taking place on the premises of the local authority where the entertainment is provided by or on behalf of the local authority;
  - any entertainment taking place on the hospital premises of the health care provider where the entertainment is provided by or on behalf of the health care provider;
  - any entertainment taking place on the premises of the school where the entertainment is provided by or on behalf of the school proprietor; and
  - any entertainment (excluding films and a boxing or wrestling entertainment) taking place at a travelling circus, provided that (a) it takes place within a moveable structure that accommodates the audience, and (b) that the travelling circus has not been located on the same site for more than 28 consecutive days.



3. Where taking place in a building or other structure please tick as appropriate (indoors may include a tent).
4. For example the type of activity to be authorised, if not already stated, and give relevant further details, for example (but not exclusively) whether or not music will be amplified or unamplified.
5. For example (but not exclusively), where the activity will occur on additional days during the summer months.
6. For example (but not exclusively), where you wish the activity to go on longer on a particular day e.g. Christmas Eve.
7. Please give timings in 24 hour clock (e.g. 16.00) and only give details for the days of the week when you intend the premises to be used for the activity.
8. If you wish people to be able to consume alcohol on the premises, please tick 'on the premises'. If you wish people to be able to purchase alcohol to consume away from the premises, please tick 'off the premises'. If you wish people to be able to do both, please tick 'both'.
9. Please give information about anything intended to occur at the premises or ancillary to the use of the premises which may give rise to concern in respect of children, regardless of whether you intend children to have access to the premises, for example (but not exclusively) nudity or semi-nudity, films for restricted age groups or the presence of gaming machines.
10. Please list here steps you will take to promote all four licensing objectives together.
11. The application form must be signed.
12. An applicant's agent (for example solicitor) may sign the form on their behalf provided that they have actual authority to do so.
13. Where there is more than one applicant, each of the applicants or their respective agent must sign the application form.
14. This is the address which we shall use to correspond with you about this application.

**15. Entitlement to work/immigration status for individual applicants and applications from partnerships which are not limited liability partnerships:**

A licence may not be held by an individual or an individual in a partnership who is resident in the UK who:

- does not have the right to live and work in the UK; or
- is subject to a condition preventing him or her from doing work relating to the carrying on of a licensable activity.

Any premises licence issued in respect of an application made on or after 6 April 2017 will become invalid if the holder ceases to be entitled to work in the UK.

Applicants must demonstrate that they have the right to work in the UK and are not subject to a condition preventing them from doing work relating to the carrying on of a licensing activity. They do this in one of two ways: 1) by providing with this application copies or scanned copies of the documents listed below (which do not need to be certified) or 2) by providing their 'share code' to enable the licensing authority to carry out a check using the Home Office online right to work checking service (see below).

**Documents which demonstrate entitlement to work in the UK**

- An expired or current passport showing the holder, or a person named in the passport as the child of the holder, is a British citizen or a citizen of the UK

and Colonies having the right of abode in the UK [please see note below about which sections of the passport to copy].

- An expired or current passport or national identity card showing the holder, or a person named in the passport as the child of the holder, is a national of a European Economic Area country or Switzerland.
- A Registration Certificate or document certifying permanent residence issued by the Home Office to a national of a European Economic Area country or Switzerland.
- A Permanent Residence Card issued by the Home Office to the family member of a national of a European Economic Area country or Switzerland.
- A **current** Biometric Immigration Document (Biometric Residence Permit) issued by the Home Office to the holder indicating that the person named is allowed to stay indefinitely in the UK, or has no time limit on their stay in the UK.
- A **current** passport endorsed to show that the holder is exempt from immigration control, is allowed to stay indefinitely in the UK, has the right of abode in the UK, or has no time limit on their stay in the UK.
- A **current** Immigration Status Document issued by the Home Office to the holder with an endorsement indicating that the named person is allowed to stay indefinitely in the UK or has no time limit on their stay in the UK, **when produced in combination with** an official document giving the person's permanent National Insurance number and their name issued by a Government agency or a previous employer.
- A **full** birth or adoption certificate issued in the UK which includes the name(s) of at least one of the holder's parents or adoptive parents, **when produced in combination with** an official document giving the person's permanent National Insurance number and their name issued by a Government agency or a previous employer.
- A birth or adoption certificate issued in the Channel Islands, the Isle of Man or Ireland **when produced in combination with** an official document giving the person's permanent National Insurance number and their name issued by a Government agency or a previous employer.
- A certificate of registration or naturalisation as a British citizen, **when produced in combination with** an official document giving the person's permanent National Insurance number and their name issued by a Government agency or a previous employer.
- A **current** passport endorsed to show that the holder is allowed to stay in the UK and is currently allowed to work and is not subject to a condition

preventing the holder from doing work relating to the carrying on of a licensable activity.

- A **current** Biometric Immigration Document (Biometric Residence Permit) issued by the Home Office to the holder which indicates that the named person can currently stay in the UK and is allowed to work relation to the carrying on of a licensable activity.
- A **current** Residence Card issued by the Home Office to a person who is not a national of a European Economic Area state or Switzerland but who is a family member of such a national or who has derivative rights or residence.
- A **current** Immigration Status Document containing a photograph issued by the Home Office to the holder with an endorsement indicating that the named person may stay in the UK, and is allowed to work and is not subject to a condition preventing the holder from doing work relating to the carrying on of a licensable activity **when produced in combination with** an official document giving the person's permanent National Insurance number and their name issued by a Government agency or a previous employer.
- A Certificate of Application, **less than 6 months old**, issued by the Home Office under regulation 17(3) or 18A (2) of the Immigration (European Economic Area) Regulations 2006, to a person who is not a national of a European Economic Area state or Switzerland but who is a family member of such a national or who has derivative rights of residence.
- Reasonable evidence that the person has an outstanding application to vary their permission to be in the UK with the Home Office such as the Home Office acknowledgement letter or proof of postage evidence, or reasonable evidence that the person has an appeal or administrative review pending on an immigration decision, such as an appeal or administrative review reference number.
- Reasonable evidence that a person who is not a national of an EEA state or Switzerland but who is a family member of such a national or who has derivative rights of residence in exercising treaty rights in the UK including:-
  - evidence of the applicant's own identity – such as a passport,
  - evidence of their relationship with the EEA family member – e.g. a marriage certificate, civil partnership certificate or birth certificate, and
  - evidence that the EEA national has a right of permanent residence in the UK or is one of the following if they have been in the UK for more than 3 months:
    - (i) working e.g. employment contract, wage slips, letter from the employer,
    - (ii) self-employed e.g. contracts, invoices, or audited accounts with a bank,
    - (iii) studying e.g. letter from the school, college or university and evidence of sufficient funds; or

(iv)self-sufficient e.g. bank statements.

Family members of European Economic Area nationals who are studying or financially independent must also provide evidence that the European Economic Area national and any family members hold comprehensive sickness insurance in the UK. This can include a private medical insurance policy, an EHIC card or an S1, S2 or S3 form.

**Original documents must not be sent to licensing authorities.** If the document copied is a passport, a copy of the following pages should be provided:-

- (i) any page containing the holder's personal details including nationality;
- (ii) any page containing the holder's photograph;
- (iii) any page containing the holder's signature;
- (iv) any page containing the date of expiry; and
- (v) any page containing information indicating the holder has permission to enter or remain in the UK and is permitted to work.

If the document is not a passport, a copy of the whole document should be provided.

Your right to work will be checked as part of your licensing application and this could involve us checking your immigration status with the Home Office. We may otherwise share information with the Home Office. Your licence application will not be determined until you have complied with this guidance.

### **Home Office online right to work checking service**

As an alternative to providing a copy of the documents listed above, applicants may demonstrate their right to work by allowing the licensing authority to carry out a check with the Home Office online right to work checking service.

To demonstrate their right to work via the Home Office online right to work checking service, applicants should include in this application their 9-digit share code (provided to them upon accessing the service at <https://www.gov.uk/prove-right-to-work>) which, along with the applicant's date of birth (provided within his application), will allow the licensing authority to carry out the check.

In order to establish the applicant's right to work, the check will need to indicate that the applicant is allowed to work in the United Kingdom and is not subject to a condition preventing them from doing work relating to the carrying on a licensable activity.

An online check will not be possible in all circumstances because not all applicants will have an immigration status that can be checked online. The Home Office online right to work checking service sets out what information and/or documentation applicants will need in order to access the service. Applicants who are unable to obtain a share code from the service should submit copy documents as set out above.

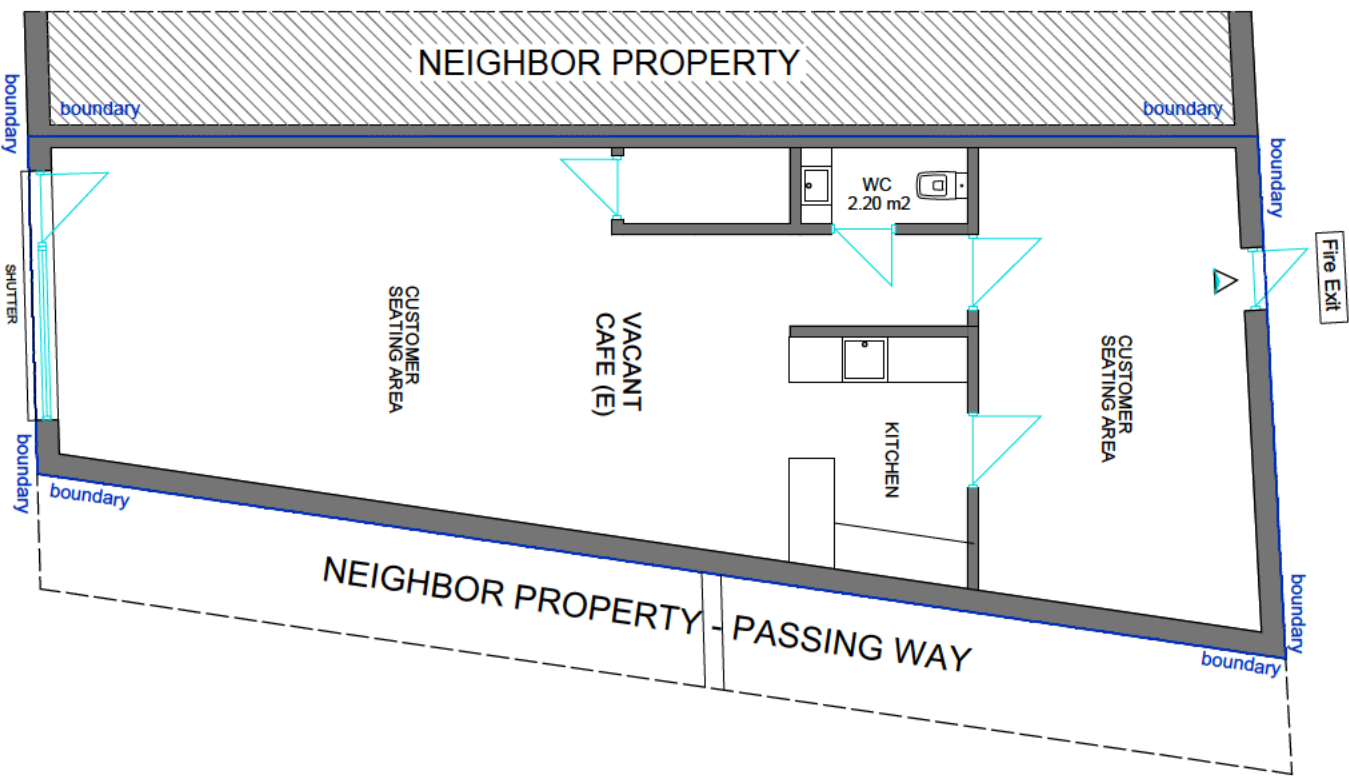

TOTAL AREA - 82.30m<sup>2</sup>  
Existing Ground Floor Plan  
1:100

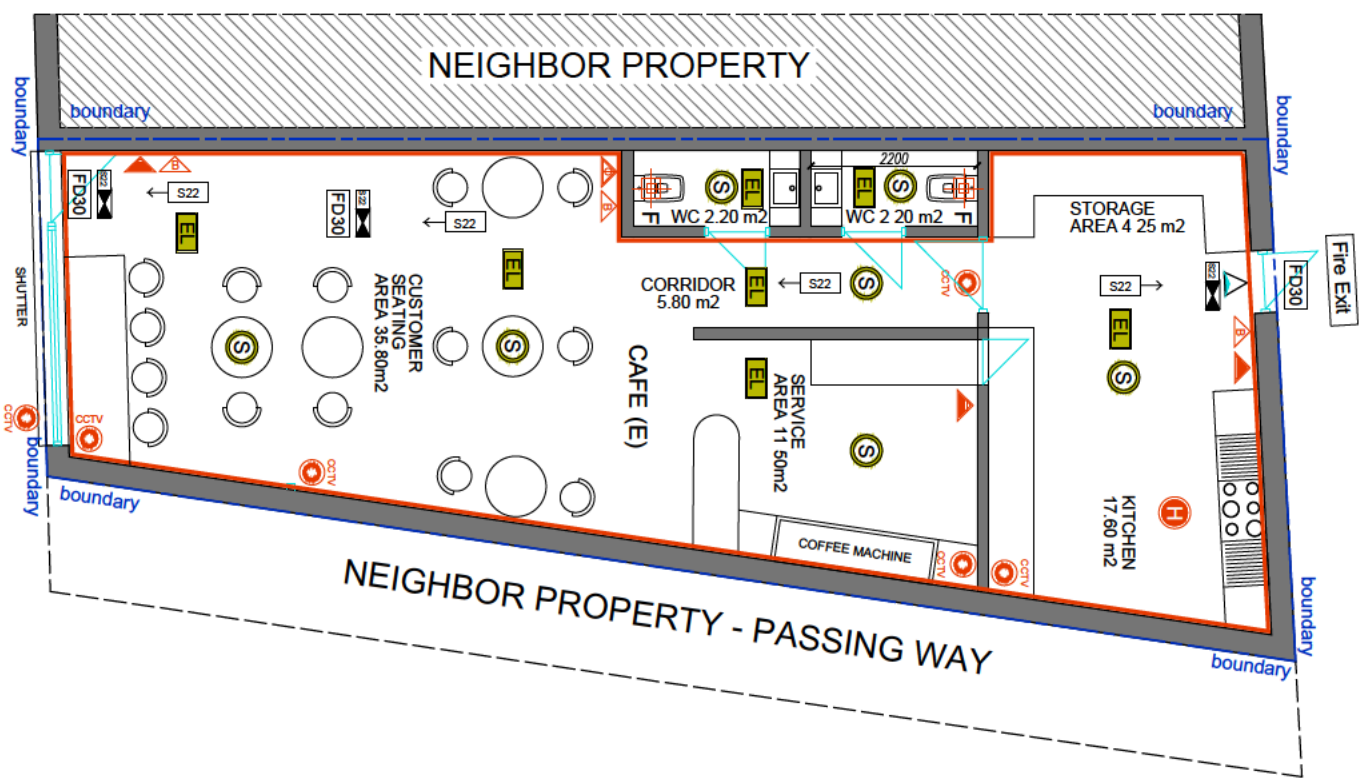

TOTAL AREA - 82.30m<sup>2</sup>  
Proposed Ground Floor Plan  
1:100

- LEGEND:**
- EXISTING WALLS
  - PROPOSED CAVITY WALLS
  - PROPOSED STUD WALLS
  - Licensing Area highlighted in red
  - CCTV
  - 30 Minutes Fire Door
  - CARBON DIOXIDE FIRE EXTINGUISHER
  - 9 LT. WATER FIRE EXTINGUISHER
  - FIRE BLANKET
  - Heat Detector
  - Smoke Detector
  - Emergency Light
  - INTERNALLY ILLUMINATED FIRE ESCAPE SIGN (BS 5266)
  - RUNNING MAN FIRE EXIT SIGN
  - MECHANICAL EXTRACT MIN. 15l/s



NOTES: THIS DRAWINGS AND WORKS SHOWN ARE THE COPYRIGHT OF NORTHPOINT PLANNING AND LICENSING SERVICES AND MAY NOT BE REPRODUCED EXCEPT WRITTEN PERMISSION. ALL FIGURED DIMENSIONS TO BE CHECKED ON SITE PRIOR TO CONSTRUCTION.



**NORTH POINT**  
PLANNING  
UK

54C CANNON HILL MEWS,  
LONDON, N14 6LH  
Mob: +44 7706 720378  
Email: info@northpointuk.co.uk  
www.northpointuk.co.uk

PROJECT:  
"CHEFS SIGNATURE"  
22 Well Street, London E9 7PX

DRAWING:  
Existing Ground Floor Plan  
Proposed Ground Floor Plan

PROPOSAL / PROJECT:  
Alcohol License

DRAWING FOR:  
Premises Licence Application

Scale: 1:100 A3  
Drawing: H.E  
Date: 03.03.2023  
Revision: 1.2

WEL-02



**RESPONSIBLE AUTHORITY REPRESENTATION:  
APPLICATION UNDER THE LICENSING ACT 2003**

**RESPONSIBLE AUTHORITY DETAILS**

NAME OF AUTHORITY	London Borough of Hackney
ADDRESS OF AUTHORITY	Community Safety & Enforcement Service First Floor Hackney Service Centre 1 Hillman Street London E8 1DY
CONTACT NAME	Jacey Frewin
TELEPHONE NUMBER	020 8356 4567
E-MAIL ADDRESS	jacey.frewin@hackney.gov.uk

**APPLICATION PREMISES**

NAME & ADDRESS OF PREMISES	Chef's Signature 22 Well Street London E9 7PX
NAME OF APPLICANT	Mr Kenan Yildirim

**COMMENTS**

I make the following relevant representations in relation to the above application to vary the Premises Licence at the above address.

- 1) the prevention of crime and disorder •
- 2) public safety •
- 3) the prevention of public nuisance **x**
- 4) the protection of children from harm •

**Representation in relation to:**

## ENVIRONMENTAL LICENCE CONDITIONS IN RESPECT OF

**Chef's Signature,  
22 Well Street, London E9 7PX**

1. The Licensee shall ensure that all relevant staff are fully trained and made aware of the legal requirement of businesses to comply with their responsibility as regards the disposal of waste produced from the business premises. The procedure for handling and preparing for disposal of the waste shall be in writing and displayed in a prominent place where it can be referred to at all times by staff.
2. The Licensee shall ensure that any contract for general and recyclable waste disposal shall be appropriate in size to the amount of waste produced by the business. The Licensee shall maintain an adequate supply of waste receptacles provided by his registered waste carrier (refuse sacks or commercial waste bins) in order to ensure all refuse emanating from the business is always presented for collection by his waste carrier and shall not use any plain black or unidentifiable refuse sacks or any other unidentifiable or unmarked waste receptacles.
3. The Licensee's premises are situated in an area within which refuse may only be left on the public highway at certain times (time bands). If the Licensee's waste carrier cannot or does not comply by collecting the refuse within an hour after the close of any time band imposed by the waste authority, the Licensee must remove the refuse from the public highway and/or keep it within the premises until such time as his/her waste carrier arrives to collect the refuse.
4. The Licensee shall instruct members of staff to make regular checks of the area immediately outside the premises and remove any litter, bottles and glasses emanating from the premises. A final check should be made at close of business.
5. The Licensee shall provide a safe receptacle for cigarette ends to be placed outside for the use of customers, such receptacle being carefully placed so as not to cause an obstruction or trip.
6. The current trade waste agreement/duty of care waste transfer document shall be conspicuously displayed and maintained in the window of the premises where it can be conveniently seen and read by persons standing in Chef's Signature. This should remain unobstructed at all times and should clearly identify:-
  - the name of the registered waste carrier
  - the date of commencement of trade waste contract
  - the date of expiry of trade waste contract
  - the days and times of collection
  - the type of waste including the European Waste Code

The above representations are supported by the following evidence and information.

We have received complaints in the past regarding littering and build-up of waste in the area. There have been instances in the past where Enforcement Officers have found evidence of the illegal disposal of waste from businesses in this area. Experience has also shown that there is the probability that there will be cigarette litter outside these premises due to the smoking ban.

Are there any actions or measures that could be taken to allay concerns or objections? If so, please explain.

contact Jacey Frewin by email

**Name:** Jacey Frewin

**Date:** 14/03/2023



# Appendix B2

## Planning Authority Representation: Application under the Licensing Act 2003

Details of Authority	1 Hillman Street, Hackney, London, E8 1FB
Officer contact name	Claudette Abraham
Officer telephone number	020 8356 4870
Officer's email address	claudette.abraham@hackney.gov.uk

### APPLICATION PREMISES

Name and address of premises	CHEFS SIGNATURE, 22 WELL STREET London E9 7PX
Applicant name	Mr Kenan Yildirim

### COMMENTS

I make the following relevant representation in relation to the above application at the above address.

- Prevention of crime and disorder
- Public safety
- Prevention of public nuisance
- Protection of children from harm

### **Please supply any relevant evidence/information to support the above representation.**

The application proposes for a new premises licence as a Cafe under the Licensing Act 2003.

The licensable activities are:

**Supply of Alcohol** Mon-Sat 07:00-22:30, Sun 08:00-22:30

**Hours of Opening** Mon-Sat 07:00-23:00, Sun 08:00-23:00

No record could be found for the approval for the use of the premises as a cafe. Therefore the applicant is advised that planning permission may be required for the usage of the premises. Operation of the premises without appropriate planning permission is unlawful and may result in enforcement action.

No representation with informatives

Please provide the following information (if applicable)

Area (that permission applies to)	Ground Floor
Permitted use	Unknown
Permitted hours	N/A
Specific/restrictive conditions	N/A
Recent applications	N/A

Decisions	N/A
Pending Decisions	N/A
Reasons for refusal	N/A
Relevant Conditions/discharges	N/A

**Are there any actions or measures that could be taken to allay concerns or objections? If so, please explain.**

**No representation**

-  
The applicant is advised that these comments do not represent a formal decision of the Local Planning Authority as to the acceptability or otherwise of the proposed use and that the decision of the Licensing Authority is not prejudicial to the determination of any subsequent planning application.

Signed	G Barnett
Name	
Date	12.04.2023

# Appendix B3

## RESPONSIBLE AUTHORITY REPRESENTATION: APPLICATION UNDER THE LICENSING ACT 2003

### RESPONSIBLE AUTHORITY DETAILS

NAME OF AUTHORITY	Metropolitan Police service
ADDRESS OF AUTHORITY	Licensing Unit, Stoke Police Station 33 Stoke Newington High Street London N16 8DS
CONTACT NAME	PC 3288CE Amanda GRIGGS
TELEPHONE NUMBER	07884 561085
E-MAIL ADDRESS	hackneylicensing@met.police.uk

### APPLICATION PREMISES

NAME & ADDRESS OF PREMISES	<b>Chefs Signature</b> <b>22 Well Street</b> <b>London</b> <b>E9 7PX</b>
NAME OF PREMISES USER	<b>Kenan Yildirim</b>

### COMMENTS

I make the following relevant representations in relation to the above application for a Premises Licence at the above address.

- 1) the prevention of crime and disorder      ◆
- 2) public safety
- 3) the prevention of public nuisance      ◆
- 4) the protection of children from harm

Representations (which include comments and/or objections) in relation to:

**Police make the following representations in relation to the application for a Premises Licence at Chefs Signature, 22 Well Street, E9 for the following reason(s);**

Police would like clarification about the premises as it is described as a ground floor café, but under the Prevention of Crime and Disorder objective it talks says Alcohol will not be consumed in the Hairdresser area of the premises. Looking at the plan I am unable to identify this area and would like to know where this is.

Police would like the following conditions as listed below these representations added to any licence issued as these will ensure the licensing objectives are upheld.

The above representations are supported by the following evidence and information.

Personal knowledge of the local area and issues in the area.

Are there any actions or measures that could be taken to allay concerns or objections? If so, please explain.

Clarification around hairdresser area, and agreement of conditions

Signed  
PC 3288CE GRIGGS  
(By E-mail)  
Name (printed)

**Proposed Conditions for  
Chef Signature, 22 Well Street, E9 7PX**



- 1) The premises shall maintain a comprehensive CCTV system as per the minimum requirements of a Metropolitan Police Crime Prevention Officer. All public areas, entry and exit points will be covered enabling frontal identification of every person entering in any light condition. The CCTV system shall continually record whilst the premises is open for licensable activities and during all times when customers remain on the premises. All recordings shall be stored for a minimum period of 31 days with date and time stamping. Recordings shall be made available immediately upon the request of Police or authorised officer.

- 2) A staff member from the premises who is conversant with the operation of the CCTV system shall be on the premises at all times when the premises are open to the public. This staff member shall be able to show Police or an authorised officer of Hackney Borough Council recent data or footage with the absolute minimum of delay when requested.
- 3) An incident log shall be kept at the premises, and made available immediately to an authorised officer of the Hackney Borough Council or the Police, which will record the following:
  - all crimes reported to the venue
  - any complaints received
  - any incidents of disorder
  - any faults in the CCTV system
  - any refusal of the sale of alcohol
  - any visit by a relevant authority or emergency service.
- 4) There shall be clear and prominent signage asking all customers to leave quietly and respect local residents.
- 5) All instances of crime or disorder to be reported by the designated premises supervisor or responsible member of staff to an agreed police contact point, as agreed with the Police.
- 6) Where the sale or supply of alcohol is taking place employees of the premises must request sight of evidence of the age of any person appearing to be under 25 years of age (Challenge 25). Such evidence may include a driving licence or passport.
- 7) The premises will display and maintain appropriate signage advising customers of the contact details of the Designated Premises Supervisor.
- 8) All staff will be given refresher training every six months on the legislation relating to the sales of alcohol to underage persons and drunken persons. Written records of this training shall be kept on the premises and produced to police or other authorised officer upon request.
- 9) There shall be no open containers or drinks taken outside the premises at any time.
- 10) Alcohol shall not be sold or supplied for consumption on the premises other than to people taking a substantial table meal from the menu and that the consumption of such alcohol is ancillary to taking table meals. This shall be served by waiter/waitress service.

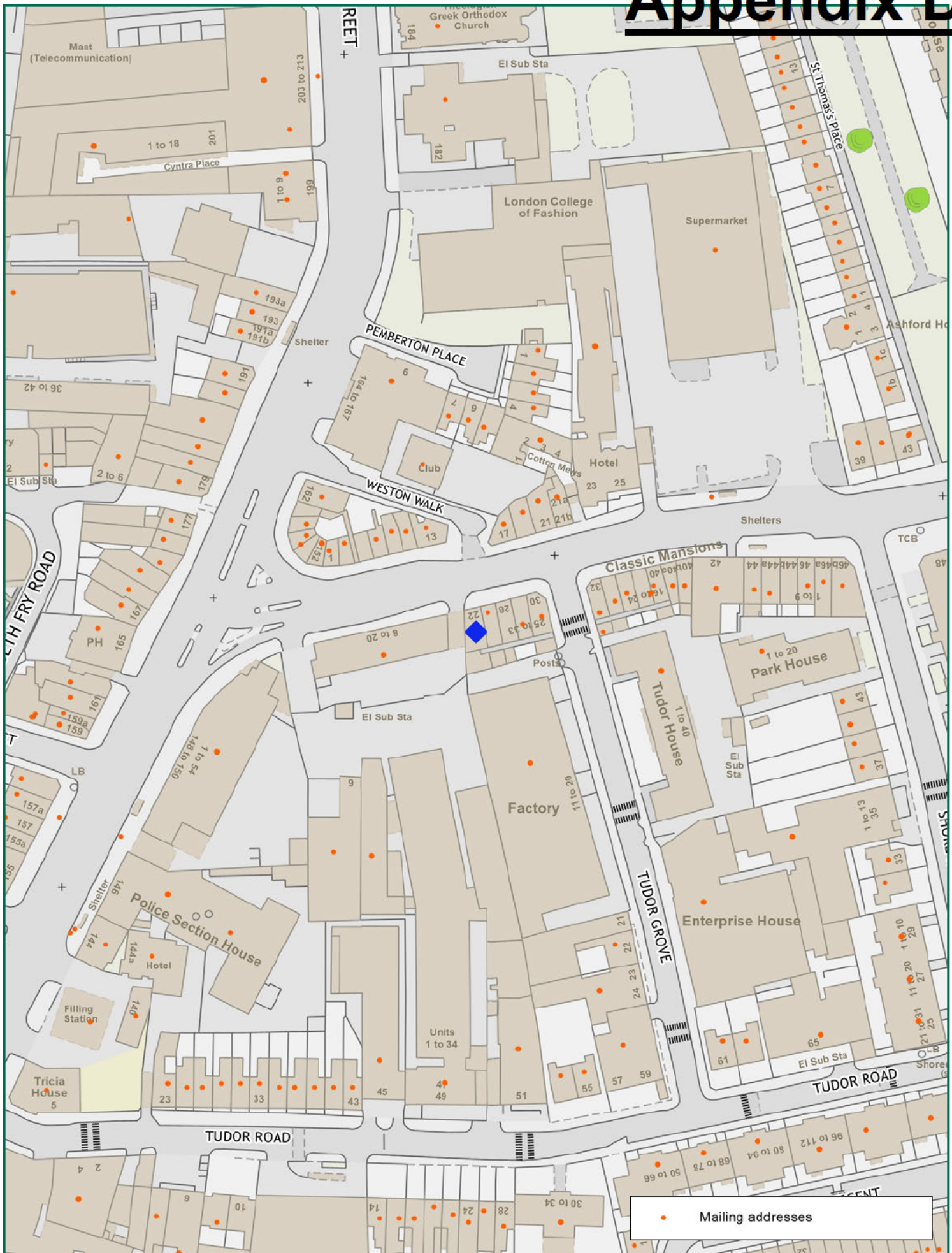
# Appendix D



• Mailing addresses

 <p>NORTH</p>			
Scale: 1:1250 at A4			
	Ref: Thursday, March 9, 2023	Produced by: unspecified email:	please specify copyright statement